



## V SERIES

Check valves fabricated from  
pressed stainless steel

**Model**  
**V Series**

**Material**  
Aisi 304 - 316

**Seal**  
NBR, EPDM, FPM, PTFE, FEP

**Pipe**  
1/2" – 4"

**PN**  
16

### Construction features

Manufacturing process: pressed stainless steel

Surface treatment degreasing, pickling and electropolishing

Seal ring  
NBR, EPDM, FPM, PTFE or FEP

Threaded ends female according to  
UNI ISO 228/1

TIG weldings without additional material

Opening pressure  
Min. 0.36 – Max. 0.50 psi  
Hydraulic test on the seal rings  
**2.9 psi**

Nominal working pressure  
**232 psi**

Working temperature  
-13°F – +194°F NBR  
-4°F – +230°F EPDM  
-4°F – +302°F FPM  
-4°F – +392°F PTFE o/or FEP

Approvals

WRAS



only Aisi 304 and 316 EPDM  
types

### Pressure temperature diagram

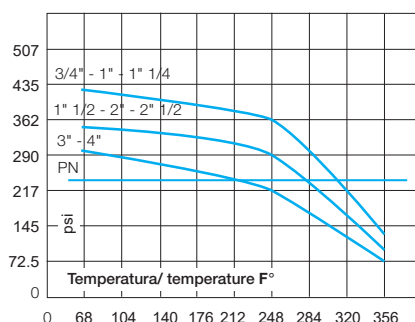

### Friction losses diagrams

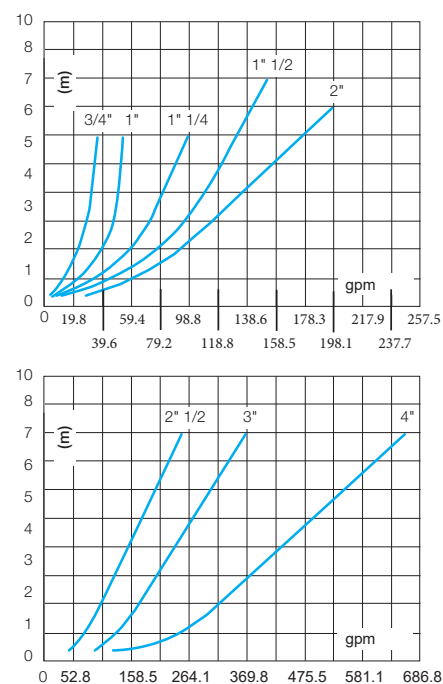

Aisi 316 FPM and 304 EPDM  
version has been certified by a third  
party to be compliant with the "Safe  
Drinking Water Act" requirements  
for low lead in potable (human  
consumption - drinking and cooking)  
and non-potable water applications  
(non-human consumption).

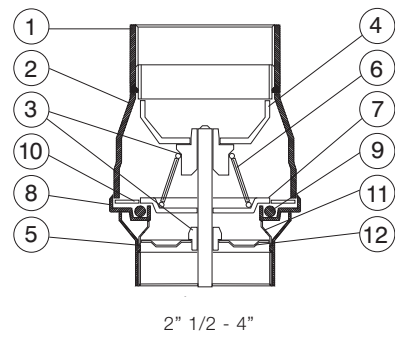
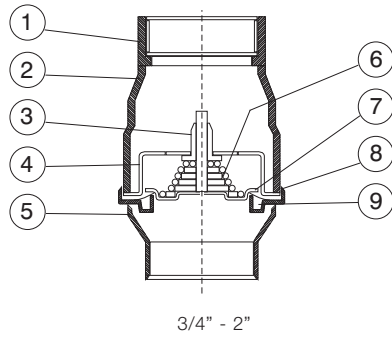

## Check Valves



## Components and materials

	Version Aisi 304	Version Aisi 316
<b>1</b> Outlet end	1.4301 / 1.4304 EN 10088	1.4401 / 1.4404 EN 10088
<b>2</b> Valve	1.4301 / 1.4304 EN 10088	1.4401 / 1.4404 EN 10088
<b>3</b> Guide bush	PTFE	PTFE
<b>4*</b> Flow control disc guide	1.4301 / 1.4304 EN 10088	1.4401 / 1.4404 EN 10088
<b>5</b> Inlet end	1.4301 / 1.4304 EN 10088	1.4401 / 1.4404 EN 10088
<b>6*</b> Spring	1.4301 / 1.4304 EN 10088	1.4401 / 1.4404 EN 10088
<b>7*</b> Flow control disc	1.4301 / 1.4304 EN 10088	1.4401 / 1.4404 EN 10088
<b>8</b> Seal ring housing	1.4301 / 1.4304 EN 10088	1.4401 / 1.4404 EN 10088
<b>9*</b> Seal ring	NBR, FPM, EPDM	EPDM, FPM, PTFE, FEP
<b>10</b> Seal ring retainer	1.4301 / 1.4304 EN 10088	1.4401 / 1.4404 EN 10088
<b>11</b> Seal ring support	1.4301 / 1.4304 EN 10088	1.4401 / 1.4404 EN 10088
<b>12</b> Inlet side guide	1.4301 / 1.4304 EN 10088	1.4401 / 1.4404 EN 10088

\* Spare parts only for versions: 2" 1/2 - 3" - 4"

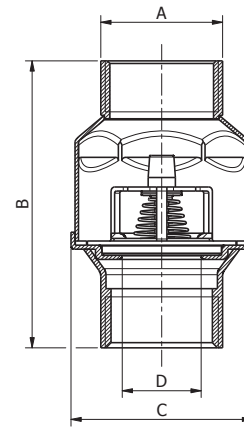

## Check Valves

### Dimensions and weights

Code	Size	Material	Seal	DN	PN	Weight in lb.	gpm	Dimensions			
								A	B	C	D
119	3/4"	Aisi 304	NBR	20	16	.28	47.5	1 3/16"	2 41/64"	1 47/64"	23/32"
169	1"			25	16	.42	82.3	1 13/32"	3 17/64"	2 3/32"	59/64"
219	1" 1/4			32	16	.61	138.6	1 49/64"	3 13/16"	2 19/32"	1 15/64"
269	1" 1/2			40	16	.85	178.3	2"	4 17/32"	3 5/64"	1 29/64"
299	2"			50	16	1.55	246.5	2 31/64"	4 3/4"	3 1/2"	1 11/16"
559	2" 1/2			65	16	3.14	303.7	3 5/32"	5 19/32"	4 29/64"	2 5/16"
129	3/4"	Aisi 304	FPM	20	16	.28	47.5	1 3/16"	2 41/64"	1 47/64"	23/32"
179	1"			25	16	.42	82.3	1 13/32"	3 17/64"	2 3/32"	59/64"
229	1" 1/4			32	16	.61	138.6	1 49/64"	3 13/16"	2 19/32"	1 15/64"
279	1" 1/2			40	16	.85	178.3	2"	4 17/32"	3 5/64"	1 29/64"
309	2"			50	16	1.55	246.5	2 31/64"	4 3/4"	3 1/2"	1 11/16"
579	2" 1/2			65	16	3.14	303.7	3 5/32"	5 19/32"	4 29/64"	2 5/16"
4029	3/4"	Aisi 316	FPM	20	16	.28	47.5	1 3/16"	2 41/64"	1 47/64"	23/32"
4129	1"			25	16	.42	82.3	1 13/32"	3 17/64"	2 3/32"	59/64"
4229	1" 1/4			32	16	.61	138.6	1 49/64"	3 13/16"	2 19/32"	1 15/64"
4329	1" 1/2			40	16	.85	178.3	2"	4 17/32"	3 5/64"	1 29/64"
4429	2"			50	16	1.55	246.5	2 31/64"	4 3/4"	3 1/2"	1 11/16"
4529	2" 1/2			65	16	3.14	303.7	3 5/32"	5 19/32"	4 29/64"	2 5/16"
4629	3"	Aisi 316	PTFE	80	16	4.59	435.8	3 21/32"	6 19/64"	5 13/64"	2 49/64"
4729	4"			100	16	7.52	796.9	4 23/32"	7 33/64"	6 37/64"	3 43/64"
4039	3/4"			20	16	.28	47.5	1 3/16"	2 29/32"	1 47/64"	23/32"
4159	1"			25	16	.42	82.3	1 13/32"	3 35/64"	2 3/32"	59/64"
4249	1" 1/4			32	16	.61	138.6	1 49/64"	3 31/32"	2 19/32"	1 15/64"
4339	1" 1/2			40	16	.85	178.3	2"	4 23/32"	3 5/64"	1 29/64"
4439	2"	Aisi 316	FEP	50	16	1.55	246.5	2 31/64"	4 3/4"	3 1/2"	1 11/16"
4559	2" 1/2			65	16	3.14	303.7	3 5/32"	5 19/32"	4 29/64"	2 5/16"
4659	3"			80	16	4.59	435.8	3 21/32"	6 19/64"	5 13/64"	2 49/64"
4759	4"			100	16	7.52	796.9	4 23/32"	7 33/64"	6 37/64"	3 43/64"

## Check Valves

Model	Material	Seal	Pipe	PN
V / OR Series	Aisi 304 - 316	FPM	3/4" – 1 1/4"	16

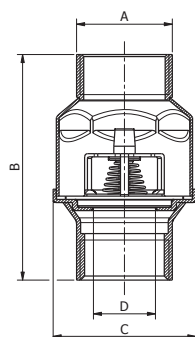

### Construction features

For use with compressed air or vacuum in low impact applications

Flow control disc: stainless steel Aisi 316 with reinforced welding between guiding pin and disc

Threaded ends female according to UNI ISO 228/1

Aisi 316 FPM version has been certified by a third party to be compliant with the "Safe Drinking Water Act" requirements for low lead in potable (human consumption - drinking and cooking) and non-potable water applications (non-human consumption).

### Dimensions and weights

Code	Size	Material	DN	PN	Weight in lb.	gpm	Dimensions			
							A	B	C	D
12R9	3/4"	Aisi 304	20	16	.28	47.5	1 3/16"	2 41/64"	1 47/64"	23/32"
17R9	1"		25	16	.42	82.3	1 13/32"	3 17/64"	2 3/32"	59/64"
22R9	1" 1/4		32	16	.61	138.6	1 49/64"	3 13/16"	2 19/32"	1 15/64"
402R9	3/4"	Aisi 316	20	16	.28	47.5	1 3/16"	2 41/64"	1 47/64"	23/32"
412R9	1"		25	16	.42	82.3	1 13/32"	3 17/64"	2 3/32"	59/64"
422R9	1" 1/4		32	16	.61	138.6	1 49/64"	3 13/16"	2 19/32"	1 15/64"

Model	Material	Seal	Pipe	PN
V / EA Series	Aisi 304	FPM	3/4" – 2"	16



### Construction features

Antipollution checkable version

In conformity with UNI EN 1717 type EA)

Inspection hole: threaded 1/8" male on suction side

Threaded ends female according to UNI ISO 228/1

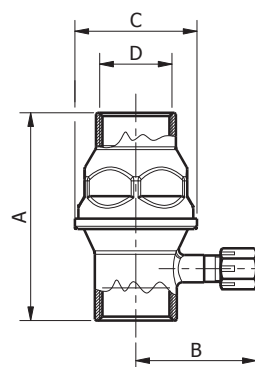

### Dimensions and weights

Code	Size	DN	PN	Weight in lb.	gpm	Dimensions			
						A	B	C	D
12T9	3/4"	20	16	.37	47.5	3 1/32"	1 21/32"	1 47/64"	3/4" F
17T9	1"	25	16	.43	82.3	3 45/64"	1 49/64"	2 3/32"	1" F
22T9	1" 1/4	32	16	.66	138.6	4 7/32"	1 59/64"	2 19/32"	1" 1/4 F
27T9	1" 1/2	40	16	.97	178.3	4 59/64"	2 3/64"	3 5/64"	1" 1/2 F
30T9	2"	50	16	1.48	246.5	4 59/64"	2 9/32"	3 35/64"	2" F



## Check Valves

Model V / DW Series	Material Aisi 304 - 316	Seal EPDM	Pipe 3/4" – 4"	PN 16
------------------------	----------------------------	--------------	-------------------	----------



### Construction features

For drinkable water

In conformity with  
UNI EN 1074-3

Working temperature  
-4°F – +230°F

Threaded ends female according to  
UNI ISO 228/1

Approvals



WRAS

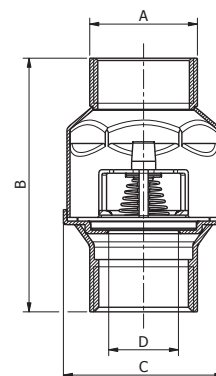

Aisi 304 version has been certified by a third party to be compliant with the “Safe Drinking Water Act” requirements for low lead in potable (human consumption - drinking and cooking) and non-potable water applications (non-human consumption).

### Dimensions and weights

Code	Size	Material	DN	PN	Weight in lb.	GPM	Dimensions			
							A	B	C	D
10A9	3/4"	Aisi 304	20	16	.28	47.5	1 3/16"	2 41/64"	1 47/64"	23/32"
15A9	1"		25	16	.42	82.3	1 13/32"	3 17/64"	2 3/32"	59/64"
20A9	1" 1/4		32	16	.61	138.6	1 49/64"	3 13/16"	2 19/32"	1 15/64"
25A9	1" 1/2		40	16	.85	178.3	2"	4 17/32"	3 5/64"	1 29/64"
28A9	2"		50	16	1.55	246.5	2 31/64"	4 3/4"	3 1/2"	1 11/16"
56A9	2" 1/2	Aisi 316	65	16	3.14	303.7	3 5/32"	5 19/32"	4 29/64"	2 5/16"
400A9	3/4"		20	16	.28	47.5	1 3/16"	2 41/64"	1 47/64"	23/32"
410A9	1"		25	16	.42	82.3	1 13/32"	3 17/64"	2 3/32"	59/64"
420A9	1" 1/4		32	16	.61	138.6	1 49/64"	3 13/16"	2 19/32"	1 15/64"
430A9	1" 1/2		40	16	.85	178.3	2"	4 17/32"	3 5/64"	1 29/64"
440A9	2"		50	16	1.55	246.5	2 31/64"	4 3/4"	3 1/2"	1 11/16"
451A9	2" 1/2		65	16	3.14	303.7	3 5/32"	5 19/32"	4 29/64"	2 5/16"
461A9	3"		80	16	4.59	435.8	3 21/32"	6 19/64"	5 13/64"	2 49/64"
471A9	4"		100	16	7.52	796.9	4 23/32"	7 33/64"	6 37/64"	3 43/64"

## Check Valves

Model	Material	Seal	Pipe	PN
V / MF Series	Aisi 304	FPM	1" – 2"	16



### Construction features

Male – female  
Threaded ends  
on suction side male according to  
UNI ISO 228/1

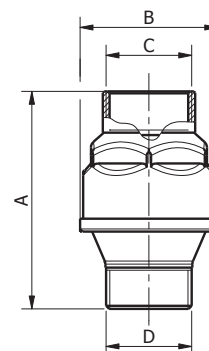

### Dimensions and weights

Code	Size	DN	PN	Weight in lb.	gpm	Dimensions			
						A	B	C	D
17MF9	1"	25	16	.36	4.94	2 <sup>63</sup> / <sub>64</sub> "	2 <sup>3</sup> / <sub>32</sub> "	1" F	1" M
22MF9	1" 1/4	32	16	.57	8.32	3 <sup>57</sup> / <sub>64</sub> "	2 <sup>19</sup> / <sub>32</sub> "	1"1/4 F	1"1/4 M
27MF9	1" 1/2	40	16	.84	10.7	4 <sup>17</sup> / <sub>32</sub> "	3 <sup>5</sup> / <sub>64</sub> "	1"1/2 F	1"1/2 M
30MF9	2"	50	16	1.31	14.79	4 <sup>27</sup> / <sub>32</sub> "	3 <sup>35</sup> / <sub>64</sub> "	2" F	2" M

Model	Material	Seal	Pipe	PN
V / MFA Series	Aisi 304	EPDM	1" – 2"	16



### Construction features

Male - female  
Threaded ends on suction side male  
UNI ISO 228/1  
Threaded ends on delivery  
female  
UNI ISO 228/1

Aisi 316 FPM type has been certified  
by a third party to be compliant with  
the "Safe Drinking Water Act"  
requirements for low lead in potable  
(human consumption - drinking and  
cooking) and non-potable water  
applications (non-human  
consumption).

### Dimensions and weights

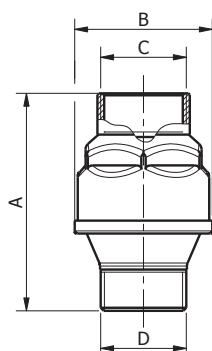

Code	Size	DN	PN	Weight in lb.	gpm	Dimensions			
						A	B	C	D
17MFA9	1"	25	16	.36	4.94	2 <sup>63</sup> / <sub>64</sub> "	2 <sup>3</sup> / <sub>32</sub> "	1" F	1" M
22MFA9	1" 1/4	32	16	.57	8.32	3 <sup>57</sup> / <sub>64</sub> "	2 <sup>19</sup> / <sub>32</sub> "	1"1/4 F	1"1/4 M
27MFA9	1" 1/2	40	16	.84	10.7	4 <sup>17</sup> / <sub>32</sub> "	3 <sup>5</sup> / <sub>64</sub> "	1"1/2 F	1"1/2 M
30MFA9	2"	50	16	1.31	14.79	4 <sup>27</sup> / <sub>32</sub> "	3 <sup>35</sup> / <sub>64</sub> "	2" F	2" M

## Check Valves

Model	Material	Seal	Pipe	PN
V / NPT Series	Aisi 304 - 316	FPM	3/4" – 2"	16



### Construction features

Aisi 316 Version: flow control disc with reinforced welding between guiding pin and disc for use with compressed air in low impact applications

Female threaded ends NPT according to ANSI B 1.20.1

Approvals

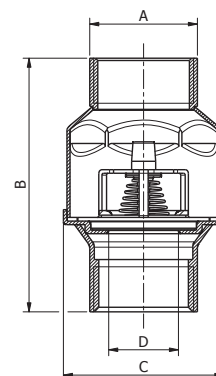

Aisi 316 FPM type has been certified by a third party to be compliant with the "Safe Drinking Water Act" requirements for low lead in potable (human consumption - drinking and cooking) and non-potable water applications (non-human consumption).

### Dimensions and weights

Code	Size	Material	DN	PN	Weight in lb.	gpm	Dimensions			
							A	B	C	D
<b>149</b>	3/4"	Aisi 304	20	16	.28	47.5	1 3/16"	2 41/64"	1 47/64"	23/32"
<b>199</b>	1"		25	16	.42	82.3	1 13/32"	3 17/64"	2 3/32"	59/64"
<b>22NPT9</b>	1" 1/4		32	16	.61	138.6	1 49/64"	3 13/16"	2 19/32"	1 15/64"
<b>27NPT9</b>	1" 1/2		40	16	.85	178.3	2"	4 17/32"	3 5/64"	1 29/64"
<b>30NPT9</b>	2"		50	16	1.55	246.5	2 31/64"	4 3/4"	3 1/2"	1 11/16"
<b>402NPTR9</b>	3/4"	Aisi 316	20	16	.28	47.5	1 3/16"	2 41/64"	1 47/64"	23/32"
<b>412NPTR9</b>	1"		25	16	.42	82.3	1 13/32"	3 17/64"	2 3/32"	59/64"
<b>422NPTR9</b>	1" 1/4		32	16	.61	138.6	1 49/64"	3 13/16"	2 19/32"	1 15/64"
<b>432NPTR9</b>	1" 1/2		40	16	.85	178.3	2"	4 17/32"	3 5/64"	1 29/64"
<b>442NPTR9</b>	2"		50	16	1.55	246.5	2 31/64"	4 3/4"	3 1/2"	1 11/16"

## Check Valves

Model	Material	Seal	Pipe	PN
V / FM + Series	Aisi 304	NBR	1" – 2"	16



### Construction Features

Female-male with connection on delivery side  
Threaded ends according to  
UNI ISO 228/1

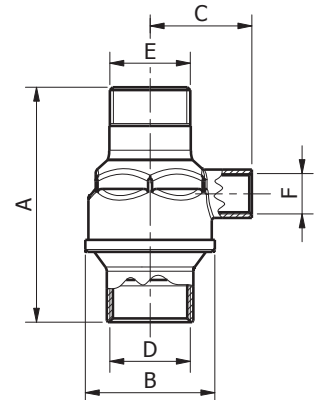

### Dimensions and weights

Code	Size	DN	PN	Weight in lb.	gpm	Dimensions					
						A	B	C	D	E	F
16A9	1"	25	16	.44	82.3	3 13/16"	2 3/32"	1 21/32"	1" F	1" M	3/8" F
21A9	1" 1/4	32	16	.67	138.6	4 29/64"	2 19/32"	1 57/64"	1"1/4 F	1"1/4 M	3/8" F
26A9	1" 1/2	40	16	.94	178.3	5 1/8"	3 5/64"	2 1/8"	1"1/2 F	1"1/2 M	3/8" F
29A9	2"	50	16	1.45	246.5	5 15/64"	3 35/64"	2 23/64"	2" F	2" M	3/8" F

Model	Material	Seal	Pipe	PN
V / VCT Series	Aisi 304	FPM	1" – 2"	16



### Construction features

Ends type Victaulic®

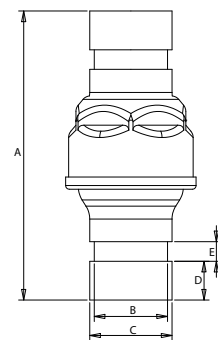

### Dimensions and weights

Code	Size	DN	PN	Weight in lb.	gpm	Dimensions				
						A	B	C	D	E
17VCT9	1"	25	25	.46	82.3	4 23/32"	1 3/16"	1 21/64"	5/8"	5/16"
22VCT9	1" 1/4	32	32	.68	138.6	4 61/64"	1 17/32"	1 43/64"	5/8"	5/16"
27VCT9	1" 1/2	40	40	.94	178.3	5 35/64"	1 49/64"	1 29/32"	5/8"	5/16"
30VCT9	2"	50	50	1.7	246.5	6 21/64"	2 1/4"	2 3/8"	5/8"	5/16"

## Check Valves

Model	Material	Seal	Pipe	PN
<b>V / FLANGE Series</b>	Aisi 304 - 316	FPM	2" – 4"	16



### Construction features

Flanged ends: flanges fabricated from pressed stainless steel with holes according to UNI EN 1092-1 PN 16

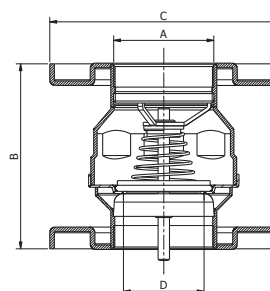

### Dimensions and weights

Code	Material	DN	PN	Weight in lb.	gpm	Dimensions				Flange	
						A	B	C	D	N. holes	Diam. holes
<b>3509</b>	Aisi 304	50	16	4.29	246.5	2 33/64"	4 27/32"	6 1/2"	1 11/16"	5/32"	45/64"
<b>3609</b>		65	16	7.15	303.7	3 5/32"	5 45/64"	7 9/32"	2 5/16"	5/32"	45/64"
<b>3559</b>	Aisi 316	50	16	4.29	246.5	2 33/64"	4 27/32"	6 1/2"	1 11/16"	5/32"	45/64"
<b>3659</b>		65	16	7.15	303.7	3 5/32"	5 45/64"	7 9/32"	2 5/16"	5/32"	45/64"
<b>3759</b>		80	16	9.11	246.5	3 57/64"	6 29/64"	7 7/8"	2 49/64"	5/16"	45/64"
<b>3859</b>		100	16	14.7	303.7	7 1/8"	7 23/32"	8 55/64"	3 43/64"	5/16"	45/64"

## Model V / F Series

**Material**  
Aisi 304 - 316

**Seal**  
FPM

**Pipe**  
2" – 4"

**PN**  
16



### Construction features

Flanged ends: flanges fabricated from pressed stainless steel with holes according to UNI EN 1092-1 PN 16

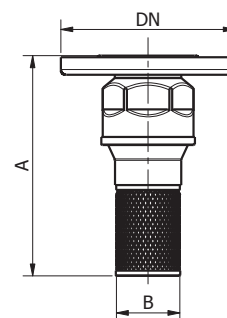

### Dimensions and weights

Code	Size	Material	DN	PN	Weight in lb.	gpm	Dimensions		
							A	B	Ø net hole
<b>350F9</b>	2"	Aisi 304	50	16	3.2	246.5	8 3/16"	2 23/64"	1
<b>360F9</b>	2" 1/2		65	16	4.94	303.7	9 1/4"	3 7/64"	1.8
<b>355F9</b>	2"	Aisi 316	50	16	3.2	246.5	8 3/16"	2 23/64"	1
<b>365F9</b>	2" 1/2		65	16	4.94	303.7	9 1/4"	3 7/64"	1.8
<b>375F9</b>	3"		80	16	6.5	435.8	10 15/32"	3 5/8"	1.8
<b>385F9</b>	4"		100	16	11	796.9	12 41/64"	4 17/32"	1.8

\*Flange dimensions: see above table