

# SUNPOWER

## CryoTel® CT

### 11 W Cryocooler



Nominal Heat Load @ 77cK (23° C reject)	11 W
--	------

Nominal Input	160 W
---------------	-------

Cooler Mass	3.1 kg
-------------	--------

Temperature Stability	± 0.1 K
-----------------------	---------

Power Supply	DC 24V (12A)
--------------	--------------

Length	261 mm
--------	--------

Diameter	83 mm
----------	-------

Lowest Temperature	< 40 K
--------------------	--------

Orientation	any
-------------	-----

AVC Compatible	yes
----------------	-----

Operating Frequency	60 Hz
---------------------	-------

MTTF	> 200,000 hr
------	--------------

Unsurpassed  
efficiency,  
reliability and  
performance.

# Base CT Cryocooler Dimensions

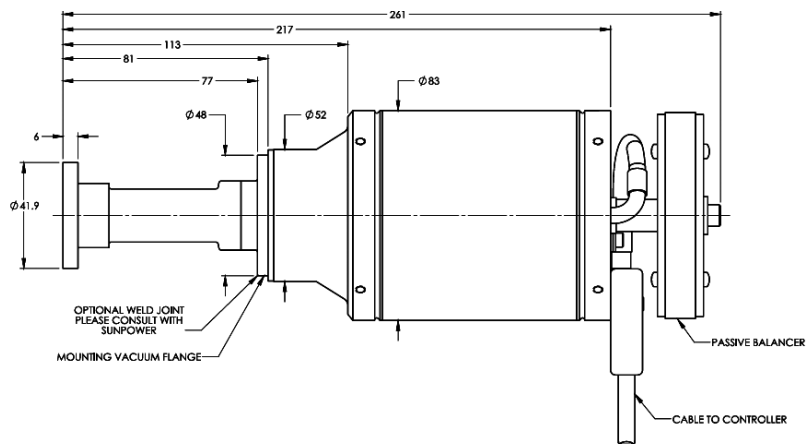
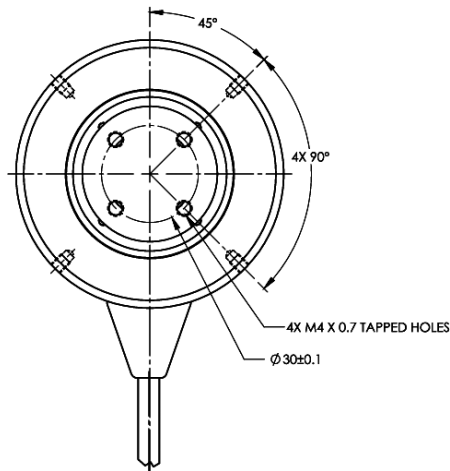

Nominal Performance to 300 K

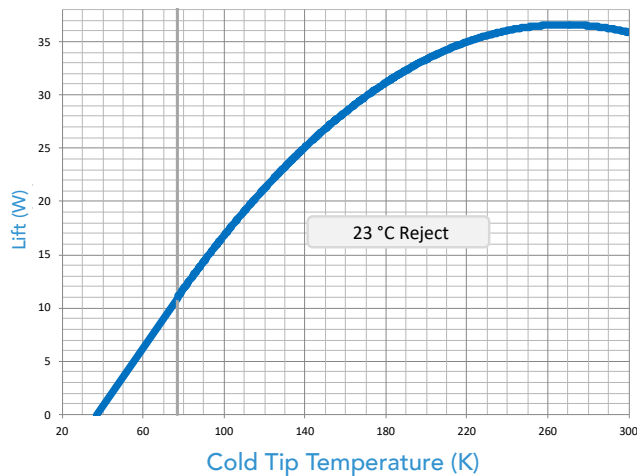

Nominal Performance at Different Reject Temperatures

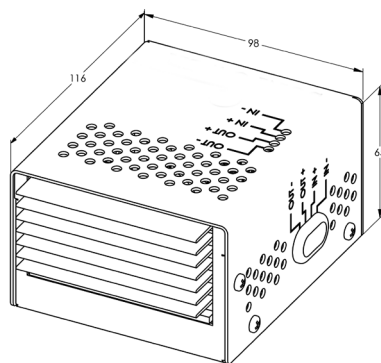
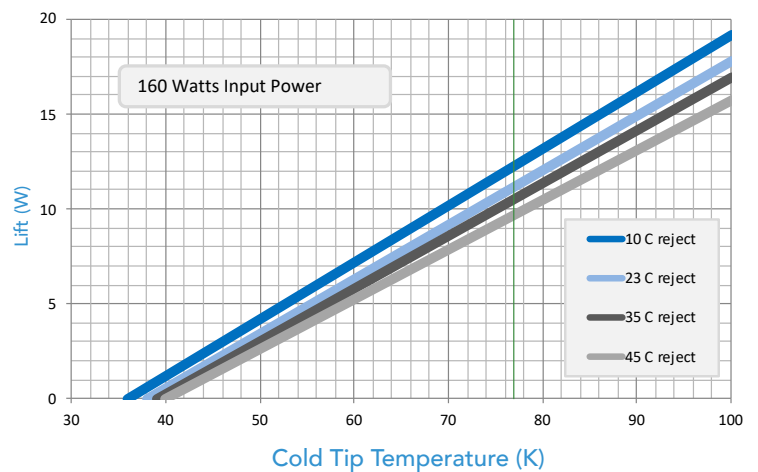

Data is subject to change.

## Performance. Efficiency. Reliability.

The CryoTel® CT cryocooler was commercialized in 2001 after 10 years of cryocooler development for Sunpower. The CT has been used successfully in applications such as High Temperature Superconductivity (HTS) filters, high altitude balloons, refrigeration, germanium detectors, IR detectors, radio telescopes, laser diode cooling, research and others. The CryoTel CT represents the smallest 11 W @77 K cooler available with a Mean Time to Failure of >200,000 hours.