



AIR ACTUATED ANGLE SEAT VALVE NP0200

SIZE 2"

BI DIRECTIONAL AIR ACTUATED ANGLE SEAT VALVE

Air Cylinder

- Material: PA, 304
- Rotation: 360°

VALVE

- Valve Body Material: 304 or 316 SS
- Sizes 3/8" to 2"
- Self-locking upon power loss or air loss in system

VALVE INTERNAL

COMPONENTS FOR POLY ACTUATOR
AND STAINLESS STEEL ACTUATOR

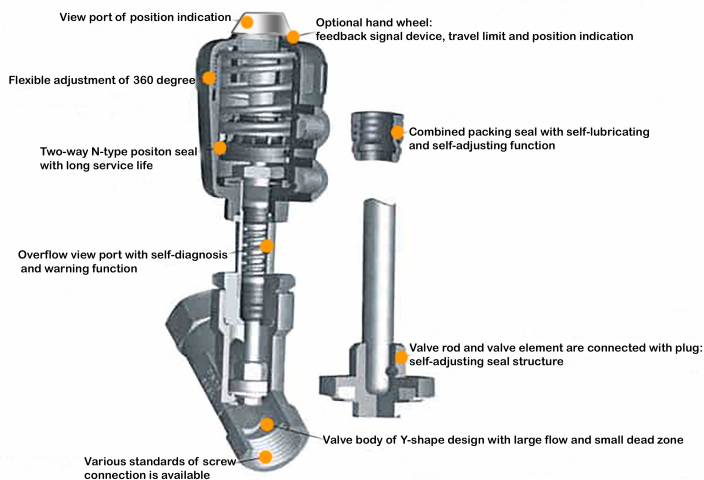

Air Placement Instructions:

Normally Closed

Air applied to port two of the actuator head releases spring tension allowing valve to open



Normally Open

Air applied to port one of the actuator head releases spring tension allowing valve to open



- System Features: suitable for steam and liquids in situations with a high requirement for water hammer prevention.
- Working Medium: 1. Ordinary type: suitable to $\leq 356^{\circ}\text{F}$ steam or gas; 2. High temperature type: suitable $\geq 356^{\circ}\text{F}$ and $\leq 482^{\circ}\text{F}$ steam or gas. It can be used for liquid under certain situations (pressure release discharge of liquid).
- Medium flow direction: medium flows to the top or bottom of valve seat.

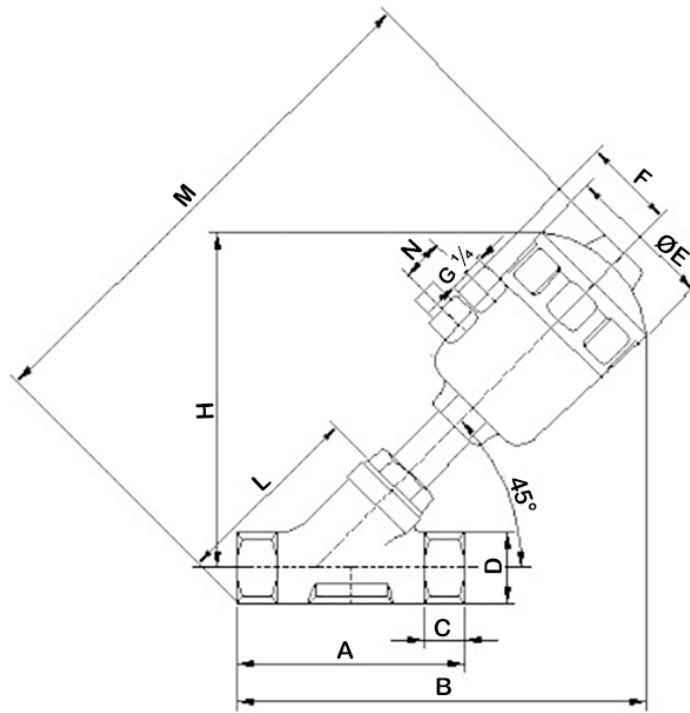

SIZE	PORT D	INNER BORE	ACTUATOR STANDARD	A	B	C	ØE	F	H	L	M	N	A/F
3/8"	3/8"	33/64"	40	2 9/16"	5 25/64"	15/32"	2 3/32"	1 27/64"	4 29/64"	2 3/4"	8 17/64"	15/16"	55/64"
1/2"	1/2"	19/32"	50	3 11/32"	6 11/16"	5/8"	2 31/64"	1 21/32"	5 45/64"	3 5/32"	8 47/64"	15/16"	1 7/64"
3/4"	3/4"	25/32"	50	3 47/64"	6 59/64"	5/8"	2 31/64"	1 21/32"	5 29/32"	3 35/64"	9 9/64"	15/16"	1 11/32"
1"	1"	1 17/64"	63	4 9/64"	8 17/64"	45/64"	3 5/32"	2 1/8"	7 11/64"	3 15/16"	11 1/32"	15/16"	1 39/64"
1 1/4"	1 1/4"	1 37/64"	63	4 23/32"	8 47/64"	45/64"	3 5/32"	2 1/8"	7 9/16"	4 9/16"	11 1/2"	15/16"	1 57/64"
1 1/2"	1 1/2"	1 31/32"	63	5 1/8"	9 1/4"	25/32"	3 5/32"	2 1/8"	7 51/64"	5 1/8"	12 1/8"	15/16"	2 11/64"
2"	2"	2 9/16"	63	5 29/32"	10 15/32"	25/32"	3 15/16"	2 23/64"	8 31/32"	6 7/64"	13 25/32"	15/16"	2 23/32"